



BMG-74

BMG SERIES

Bottom Mounted Medium Temp Glass Door Merchandisers

The only bottom mounted glass door reach-ins with low maintenance bare tube condenser coils.



MODELS

- | | |
|---------------------------------|---------------------------------|
| <input type="checkbox"/> BMG-27 | <input type="checkbox"/> BMG-74 |
| <input type="checkbox"/> BMG-48 | <input type="checkbox"/> BMG-80 |
| <input type="checkbox"/> BMG-52 | |

FEATURES

CONSTRUCTION

- 24 gauge painted steel interior and exterior
- Cord and plug standard on all self-contained models
- Replaceable magnetic vinyl door gaskets
- 5 white epoxy-coated, heavy-duty, welded wire shelves per door (4 cantilever and one bottom)
- Cantilever shelves are two-position and adjustable in 1" increments
- Equipped with high output 800 milliamp lamps and ballasts
- Independent on/off light switch
- 2" foamed-in-place "zero ODP" urethane insulation

FINISH

- Sparkling white polyester enamel interior and exterior

DOORS

- Door size:
 BMG-2730" x 63"
 BMG-48/74 25¹/₈" x 63"
 BMG-52/80 27¹/₈" x 63"
- Black door rails and handles
- Extra large, auto-close, triple pane, safety glass doors
- 90° hold-open feature
- Adjustable torsion bar hinges
- Anthony Torque Master[®] door hinges easily adjustable for closing tension and leveling

REFRIGERATION

- Self-contained, factory tested, bottom mounted refrigeration system
- Top mounted low profile interior fan housing
- Automatic condensate evaporator
- Refrigerant: R-134a

- Temperature range: 34° to 41°F (1° to 5°C)
- R-factor (insulation efficiency rating): 17.24

WARRANTY

- Standard limited four year extended compressor and one year limited parts and labor

OPTIONS

- Add suffix "R" for remote system (BMG-48 and BMG-74 only)
- Custom colors
- Price tag molding
- Baskets
- Extra shelves
- Casters



BMG SERIES BOTTOM MOUNTED MEDIUM TEMP GLASS DOOR MERCHANDISERS

TECHNICAL SPECIFICATIONS

MODEL	DIMENSIONS (in.)			DIMENSIONS (mm)			VOLTS	AMPS	UNIT H.P.	NO. OF DOORS	CAP. CU. FT.	SHIP CU. FT.	SHIP WT. (LB/KG)
	L	D	H	L	D	H							
BMG-27	31	35 ³ / ₈	79	787	899	2007	115	8.0	1/3	1	27.5	79.0	520/236
BMG-48	52	35 ³ / ₈	79	1321	899	2007	115	8.0	1/3	2	49.0	117.0	755/343
BMG-52	56	35 ³ / ₈	79	1422	899	2007	115	8.0	1/3	2	53.0	128.0	775/352
BMG-74	78	35 ³ / ₈	79	1981	899	2007	115	12.0	1/2	3	75.5	168.0	1025/466
BMG-80	84	35 ³ / ₈	79	2134	899	2007	115	12.0	1/2	3	81.6	185.0	1065/484

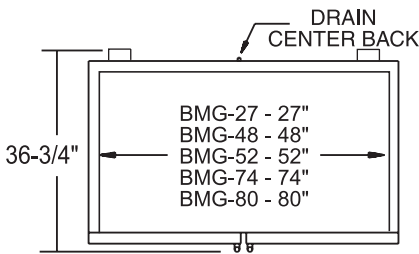

PLAN VIEW

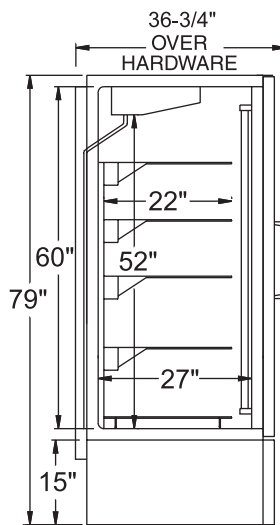

SIDE VIEW

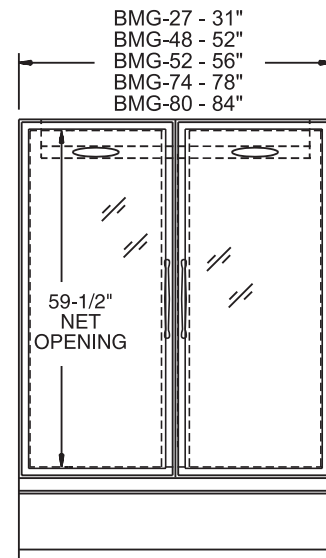

ELEVATION VIEW

LISTINGS



HOOKUP

Via plug in, 9 foot long, flexible three wire 14/3 cord with molded plug.



BID SPECIFICATIONS

Item no. BMG- _____ .
Provide _____ ()
Bottom Mounted Medium Temp Glass Door Merchandiser(s), Master-Bilt model no. BMG- _____ .

Merchandiser to be provided with adjustable torsion bar hinges, top mounted low profile interior fan housing, automatic

condensate evaporator, 800 milliamp bulbs, independent on/off light switch and black door rails and handles. Merchandiser also to be equipped with five white epoxy-coated shelves (four cantilever and one bottom) per door.

The refrigeration system is to be bottom mounted, self-contained and use R-134a

refrigerant. System will contain a low maintenance bare tube condenser coil. The temperature range will be 34° to 41°F (1° to 5°C).

Merchandiser to have standard limited four year extended compressor warranty and one year limited parts and labor warranty. Merchandiser to be UL, C-UL and NSF listed.

NOTE: Cabinet designed for optimum performance in air-conditioned area at 75°F ambient and 55% relative humidity. All specifications subject to change without notice.



908 Highway 15 North • New Albany, MS 38652
PHONE: 800-647-1284 or 662-534-9061 • FAX: 800-232-3966 or 662-534-6049 • www.master-bilt.com

